

Straight Type

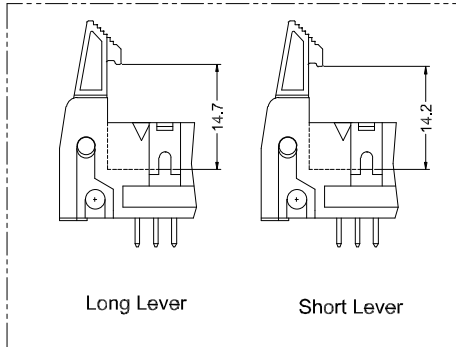

Long Lever

Short Lever

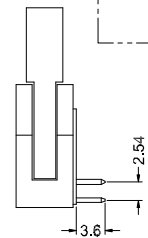
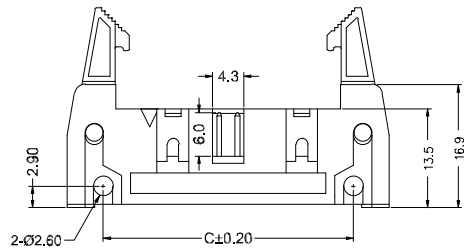
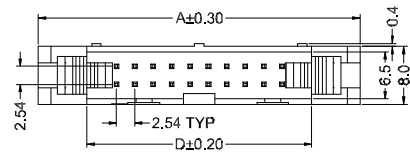

Right Angle Type

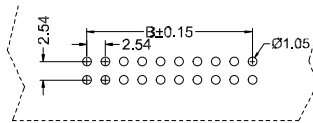

P.C.B Layout

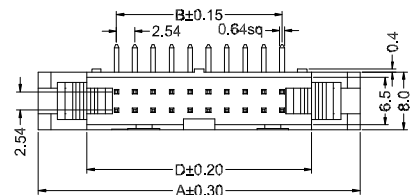

材质 Material:

绝缘体 Insulator: Glass filled PBT UL94V-0

接触件 Contacts: Brass

电镀层 Plating: Whole Gold plated over Nickel

电气性能 Electrical Characteristics:

接触电阻 Contact Resistance: 20mΩmax. at DC 100mA

绝缘电阻 Insulator Resistance: 1000MΩmin. at 500V DC

耐压 Withstanding Voltage: 1000V AC/rms 50Hz For 1 minute

工作电流 Current Rating: 2 AMP

使用温度范围 Operating Temperature: -55°C ~ +105°C

Dimension

position	A	B	C	D
06	26.52	5.08	16.76	13.22
08	29.06	7.62	19.30	15.76
10	31.60	10.16	21.84	18.30
14	36.68	15.24	26.92	23.38
16	39.22	17.78	29.46	25.92
20	44.30	22.86	34.54	31.00
26	51.92	30.48	42.16	38.62
30	57.00	35.56	47.24	43.70
34	62.08	40.64	52.32	48.78
40	69.70	48.26	59.94	56.40
50	82.40	60.96	72.64	69.10
60	95.10	73.66	85.34	81.80
64	100.18	78.74	90.42	86.88

TITLE EJECTOR HEADER 2.54mm

DC2型牛角插针(全金)

SERIES QC202

CUSTOMER P/N

UNITS mm

SCALE 1:1

PROJECTION



GENERAL TOLERANCE

x.: ±0.3

x.x: ±0.2

x.xx: ±0.1

ANGLE TOLERANCE

x.: ±2°

x.x: ±1°

x.xx: ±0.5°

DRAWN BY DATE

CHECKED BY DATE

張國校

APPROVED BY DATE

CHIZON CHIZON(CI XI)
ELECTRONIC CO.,LTD.

啓宸(慈溪)電子有限公司

DRAWING NO. SHEET 1 OF 1

SHEET SIZE A4 REV. AO

SCALE DESCRIPTION CHK DATE